

1. Manufacturer's Declaration

The manufacturer, Georg Fischer Piping Systems Ltd, CH-8201 Schaffhausen (Switzerland) declares, in accordance with the harmonized prEN ISO 16135:2001 that the Butterfly Valves Type 567/ 568

1. are pressure-bearing components in the sense of the EC Directive 97/23/EC concerning pressure equipment and that they meet the requirements pertaining to valves as states in this directive,

2. correspond to the respective requirements for valves pursuant to Directive 89/106/EC concerning building products.

The CE-emblem on the valve refers to this accordance [as per the directive on pressure equipment, only valves larger than DN 25 can be labeled with CE].

Operation of these butterfly valves is prohibited until conformity of the entire system into which the butterfly valves have been installed is established according to one of the above mentioned EC-Directives.

Modifications on the butterfly valve which have an effect on the given technical specifications and the intended use render this manufacturer's declaration nullt and void. Additional information is contained in the «Georg Fischer Planning Fundamentals» [see Paragraph 9].

Schaffhausen, 01.10.2005

Managing Director
Industrial Systems

Authorized Quality
Management Agent

Instruction manuals on parts and units for additional functions for type 567 / 568:	
Bedienungsanleitung	Fi-Nummer
Butterfly Valve Type 567 / 568	5906/1, 4
Integrated Electric Feedback	5939/1, 4
Intermediate Element for BUV 567/568	5918/1, 4
Electric Actuator Unit	5886/1, 4
Pneumatic Actuator Unit PA30- PA90	5377/1, 2, 4d

1.3 Assembly instruction for intermediate element gear operator

Code number: 198.000.599
Suitable for the nominal diameters:
DN 150
DN 200

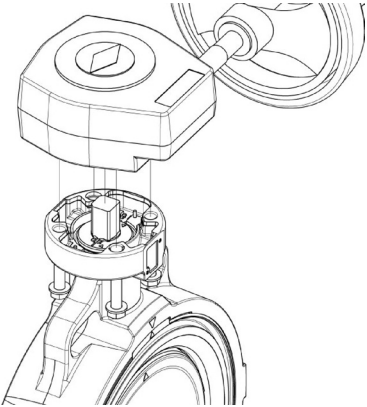

2.1 Assembly instruction for intermediate element pneumatic actuator type PA

Code number: 198.00.595
Suitable for the nominal diameters and functions:
DN 50 double acting (DA)
DN 50 fail safe to open (FO)
DN 50 fail safe to close (FC)
DN 65 DA, FC, FO
DN 80 DA

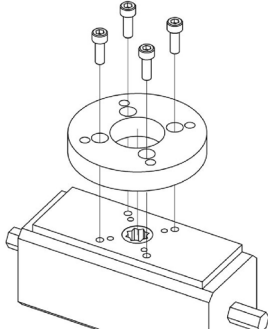

Step 2

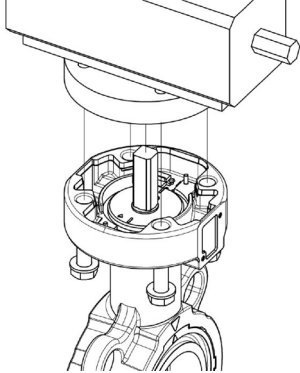

2.2 Assembly instruction for intermediate element pneumatic actuator type PA

Code number: 198.000.596
Suitable for the nominal diameters and functions:
DN 80 FC
DN 80 FO

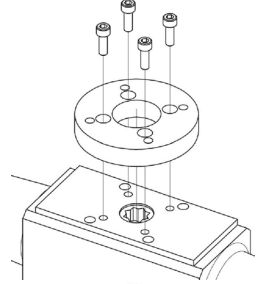

Step 2

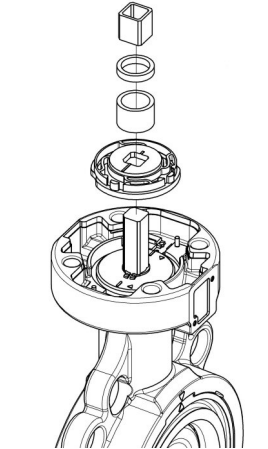

Step 3

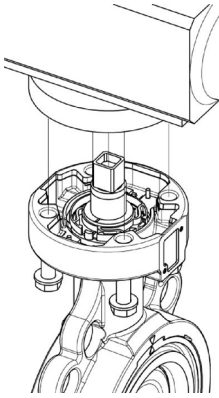

2.3 Assembly instruction for intermediate element pneumatic actuator type PA

Code number: 198.000.600
Suitable for the nominal diameters and functions:
DN 100 DA
DN 100 FC
DN 100 FO
DN 125 DA
DN 150 DA
DN 200 DA

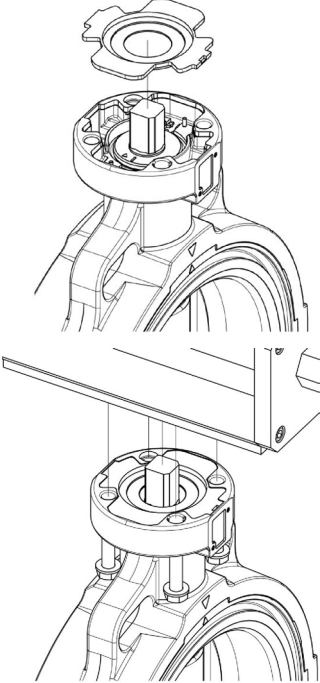

Step 2

2.4 Assembly instruction for intermediate element pneumatic actuator type PA

Code number: 198.000.597
Suitable for the nomii
DN 125 FC
DN 125 FO

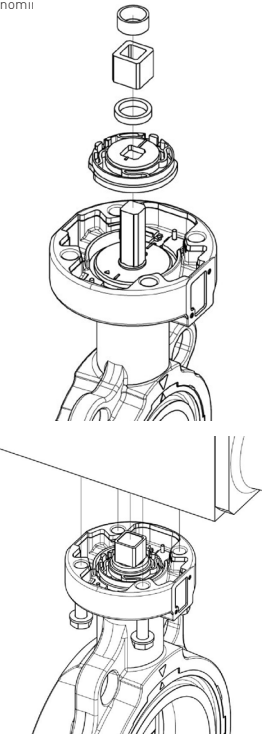

Step 1

Step 2

2.5 Assembly instruction for intermediate element pneumatic actuator type PA

Code number: 198.000.599
Suitable for the nominal diameters and functions:
DN 150 FC
DN 150 FO

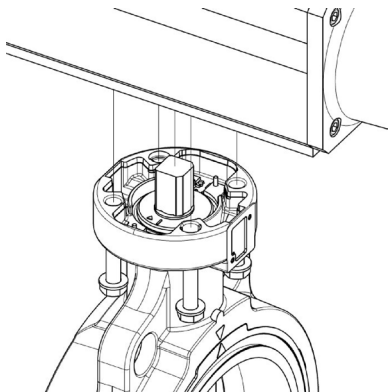

2.6 Assembly instruction for intermediate element pneumatic actuator type PA

Code number: 198.000.598
Suitable for the nominal diameters and functions:
DN 200 FC
DN 200 FO

Step 1



Step 2

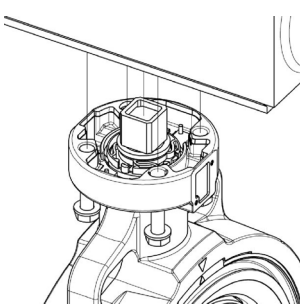

3.1 Assembly instruction for intermediate element electric actuator type EA 31

Code number: 198.000.601
Suitable for the nominal diameters:
DN 50
DN 65
DN 80

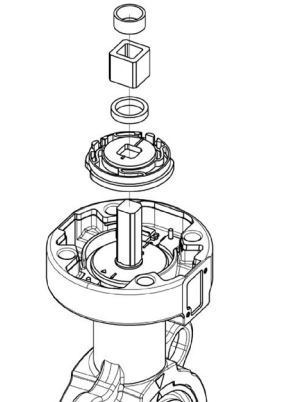

Step 1

Step 2

3.2 Assembly instruction for intermediate element electric actuator type EA 31

Code number: 198.000.602
Suitable for the nominal diameters:
DN 100
DN 125

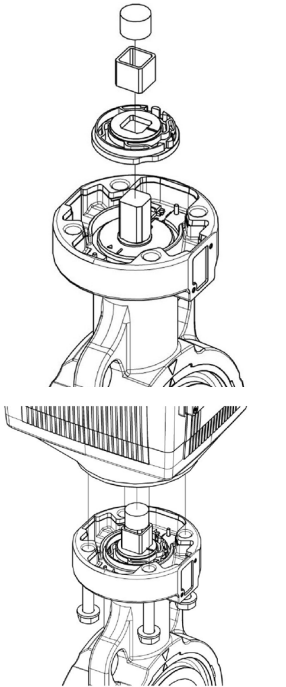

Step 1

Step 2

3.3 Assembly instruction for intermediate element electric actuator type EA 31

Code number: 198.000.599
Suitable for the nominal diameter:
DN 150

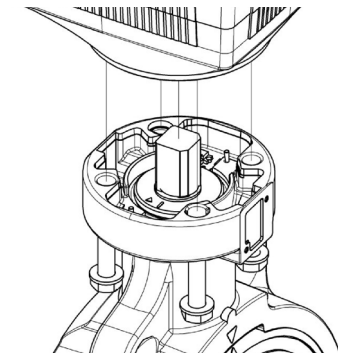

3.4 Assembly instruction for intermediate element electric actuator type EA 42

Code number: 198.000.603
Suitable for the nominal diameter:
DN 200

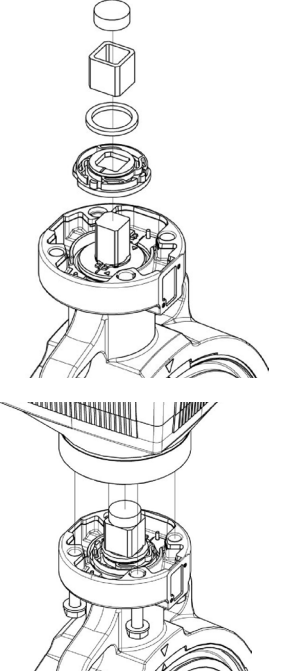

Step 2

+GF+

GEORG FISCHER
PIPING SYSTEMS

Georg Fischer Piping Systems Ltd.
CH-8201 Schaffhausen (Switzerland)
Phone +41(0)52 631 30 26
info.ps@georgfischer.com
www.type567.georgfischer.com
www.piping.georgfischer.com

GMST 5918/1, 4
© Georg Fischer Piping Systems Ltd.

General reference:
The butterfly valves type 567/568 in the dimensions DN 50 to DN 200 have a F07 interface according to ISO 5211.

1.1 Assembly instruction for intermediate element gear operator

Code number: 198.000.621
Suitable for the nominal diameters:
DN 50
DN 65
DN 80

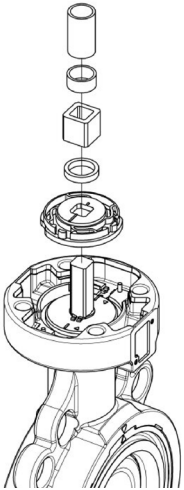

Step 1

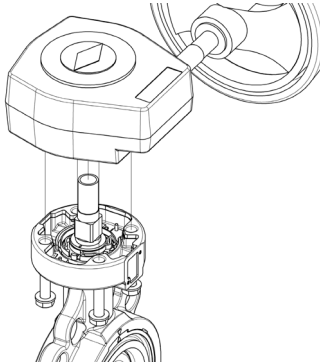

Step 2

1.2 Assembly instruction for intermediate element gear operator

Code number: 198.000.622
Suitable for the nominal diameters:
DN 100
DN 125

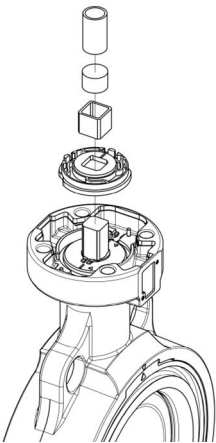

Step 1

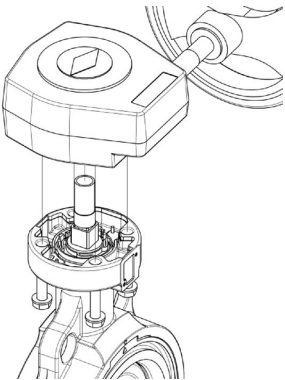

Step 2